



- ASSEMBLY AND INSTALLATION -

INSTRUCTIONS FOR ECLISSE CURVED SLIDING POCKET DOOR KITS

SINGLE



DOUBLE (from page 6)



SINGLE FRAME ASSEMBLY

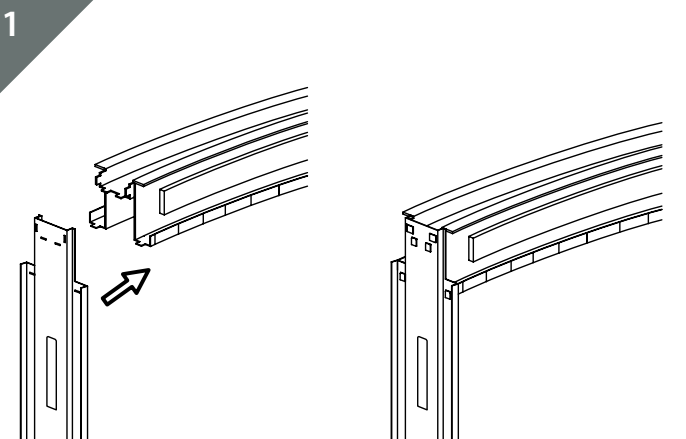

1
Remove the metal door post from the rear of the pocket and attach to the end of the track, bending the metal tongues over.

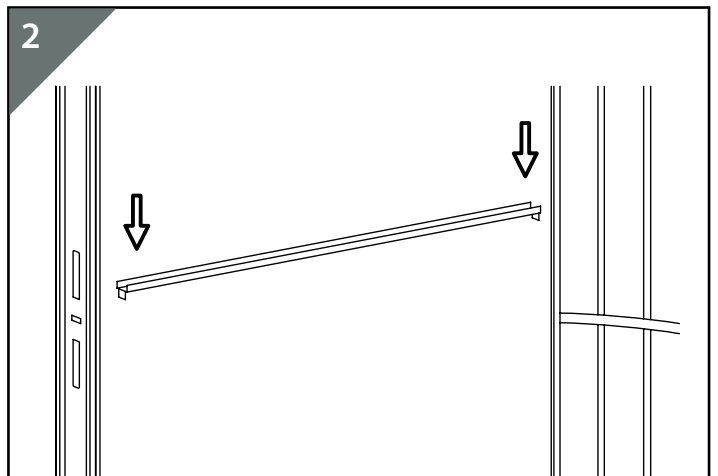

2
Insert the two spacers into their predetermined locator points as shown.

SINGLE FRAME ASSEMBLY

3

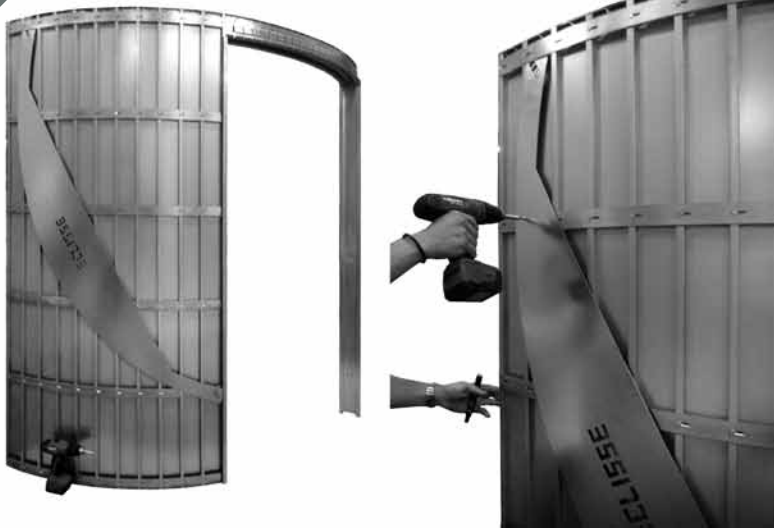

3a) Template fixed to the rear of the pocket.

3b) Unscrew.



3c) Position the template exactly where you want the pocket installed and trace around its edge.

4

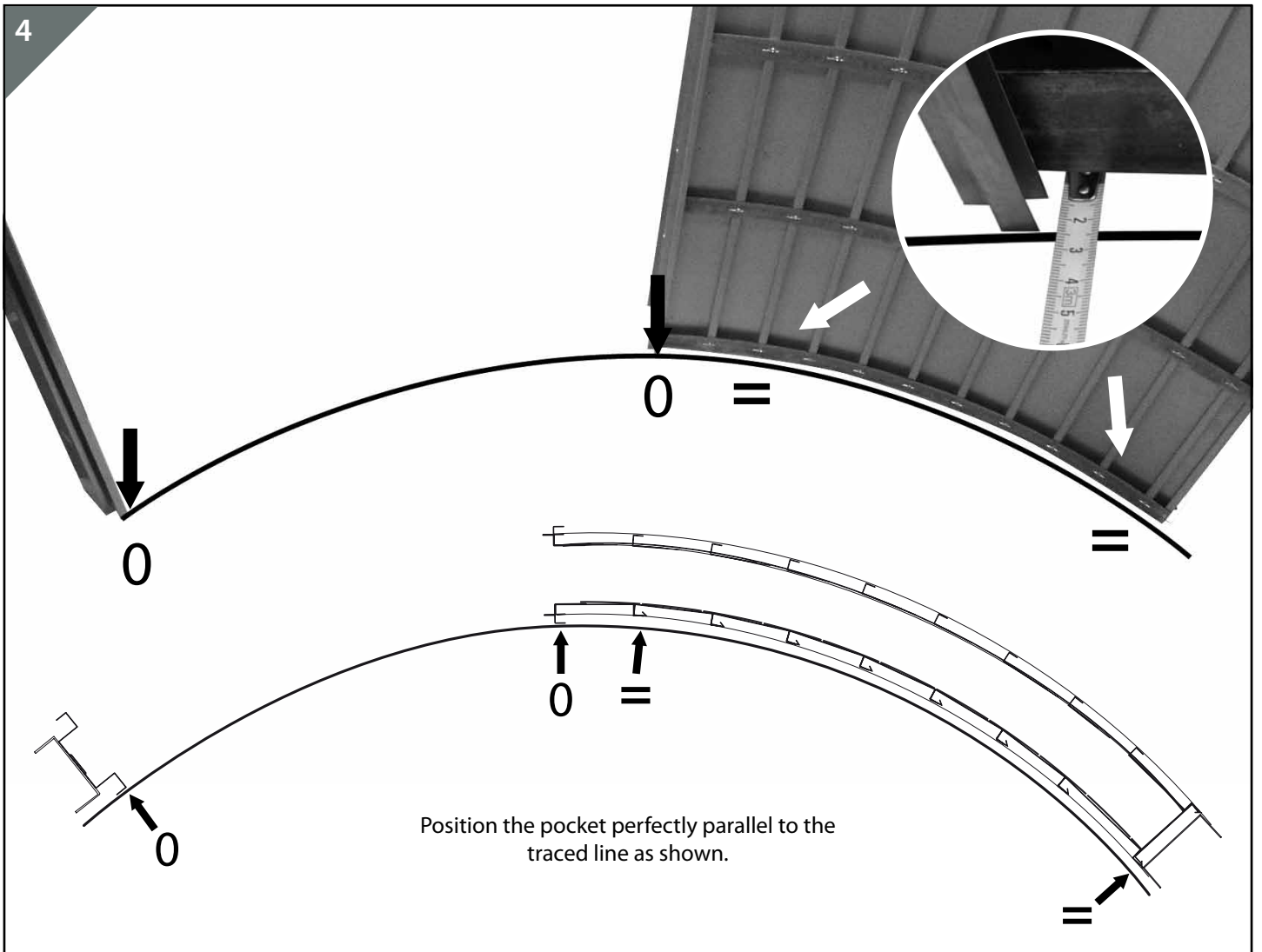

Position the pocket perfectly parallel to the traced line as shown.

SINGLE FRAME ASSEMBLY

5

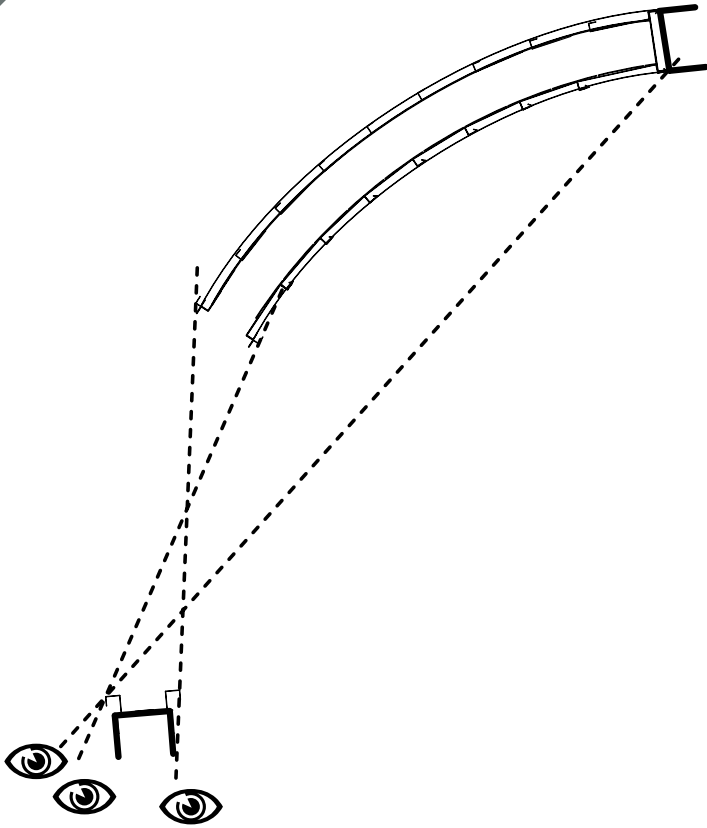

The frame must be perfectly vertical and in line, so centre it between the structure and view down the sight lines to check.

6a

PLASTERBOARD

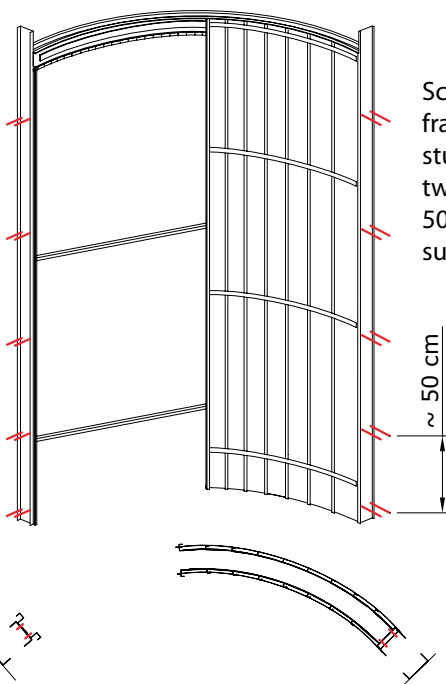

Screw the framework into the stud work using two screws every 50 cm (screws not supplied).

~ 50 cm

6b

SOLID WALL

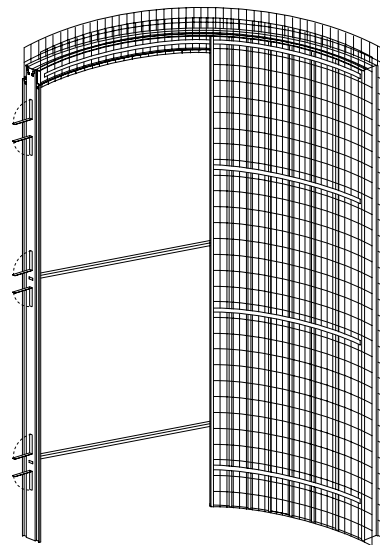

Bend the ties on the door post outwards and cement into the structure.

7a

PLASTERBOARD

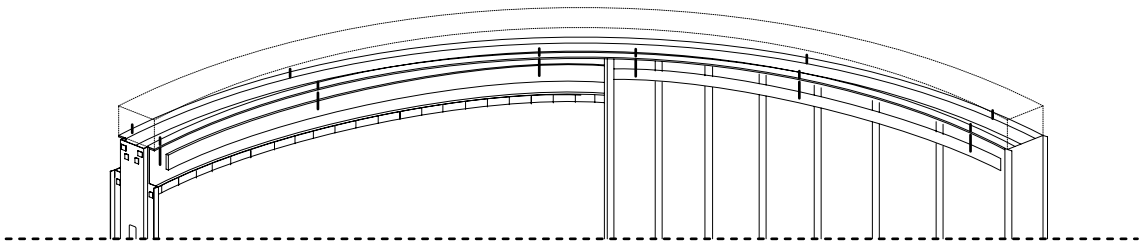

Fix the top rail to the stud work above the rail by drilling holes in the outer wings of the rail and screwing into the stud work. If you are using wooden stud then a screw each side every 40 cm. is adequate. If you are using metal stud work cut along the side to obtain the curvature then we recommend that each cut section is screwed to the outer wings of the rail.

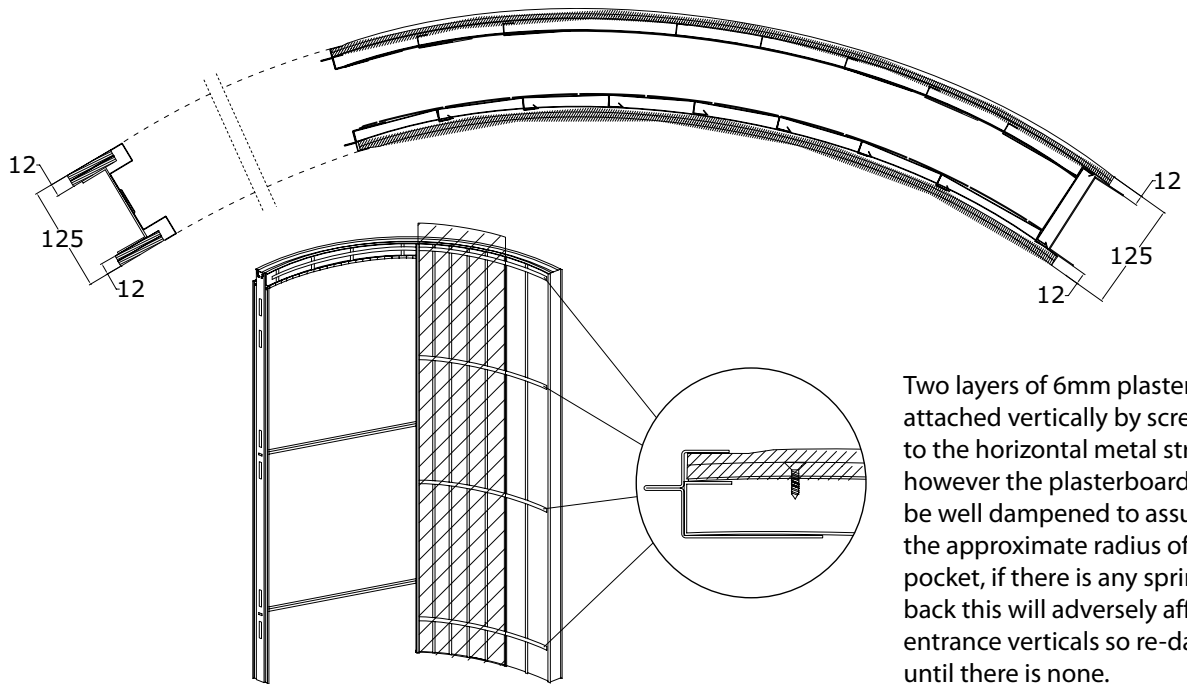

Two layers of 6mm plasterboard attached vertically by screws to the horizontal metal strips, however the plasterboard must be well dampened to assume the approximate radius of the pocket, if there is any spring back this will adversely affect the entrance verticals so re-dampen until there is none.

- 1) Drill the plasterboard and the steel horizontals with a 2 mm drill.
- 2) Screw the first sheet to the horizontals using the screws provided.
- 3) Drill through the first and second sheets and the horizontals.
- 4) Fix the second sheet using the screws provided.

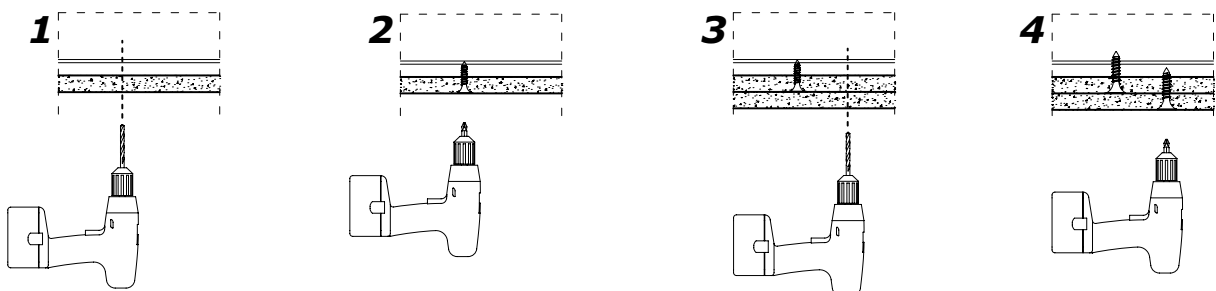
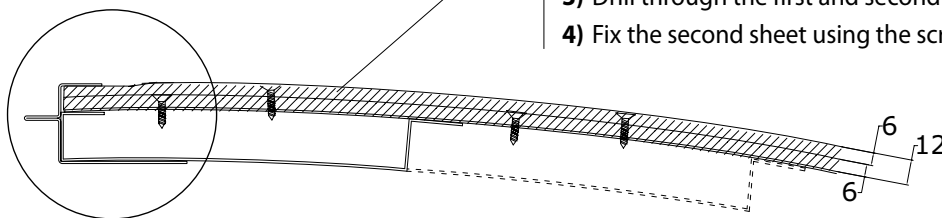

7b

SOLID WALL

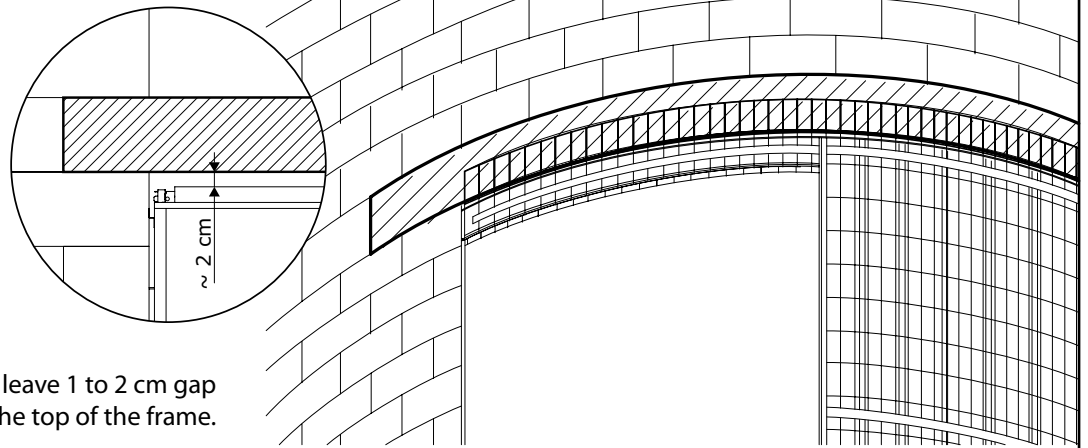

A lintel is required but leave 1 to 2 cm gap between it and the top of the frame.

APPLY MORTAR TO THE FRAME AS FOLLOWS

The metal framework, when covered with mortar, becomes an integral part of the wall so please ensure these instructions are followed carefully for maximum rigidity.

MORTAR COMPOSITION:

- **Cement mortar for walls**
(up to 3mm grain)
EN998-2
- **Add 15% Portland cement**
EN197-1 CEM11/B – L32,5N
- **Tap Water according to the mortar instructions**

FIRST STEP - MORTAR COAT TO THE MESH

- Using the back of the trowel and a flicking action apply the mortar until it just covers the mesh and roughly smooth to that level
- **IMPORTANT: LEAVE TO DRY FOR AT LEAST 15 DAYS**

SECOND STEP - FINAL MORTAR COAT

- Using the same mix as in the first phase apply the mortar and level to the desired finished wall thickness and leave to dry completely
- this will take a few days

THIRD STEP – FINISH PLASTERING

- Make sure that the surface is dry and apply a coat of plaster with the proper mix

Warning: Avoid high thermal shock during use - recommended temperature range is between + 5° C and + 30° C
Do not apply mortar to frozen framework.

DOUBLE FRAME ASSEMBLY

8

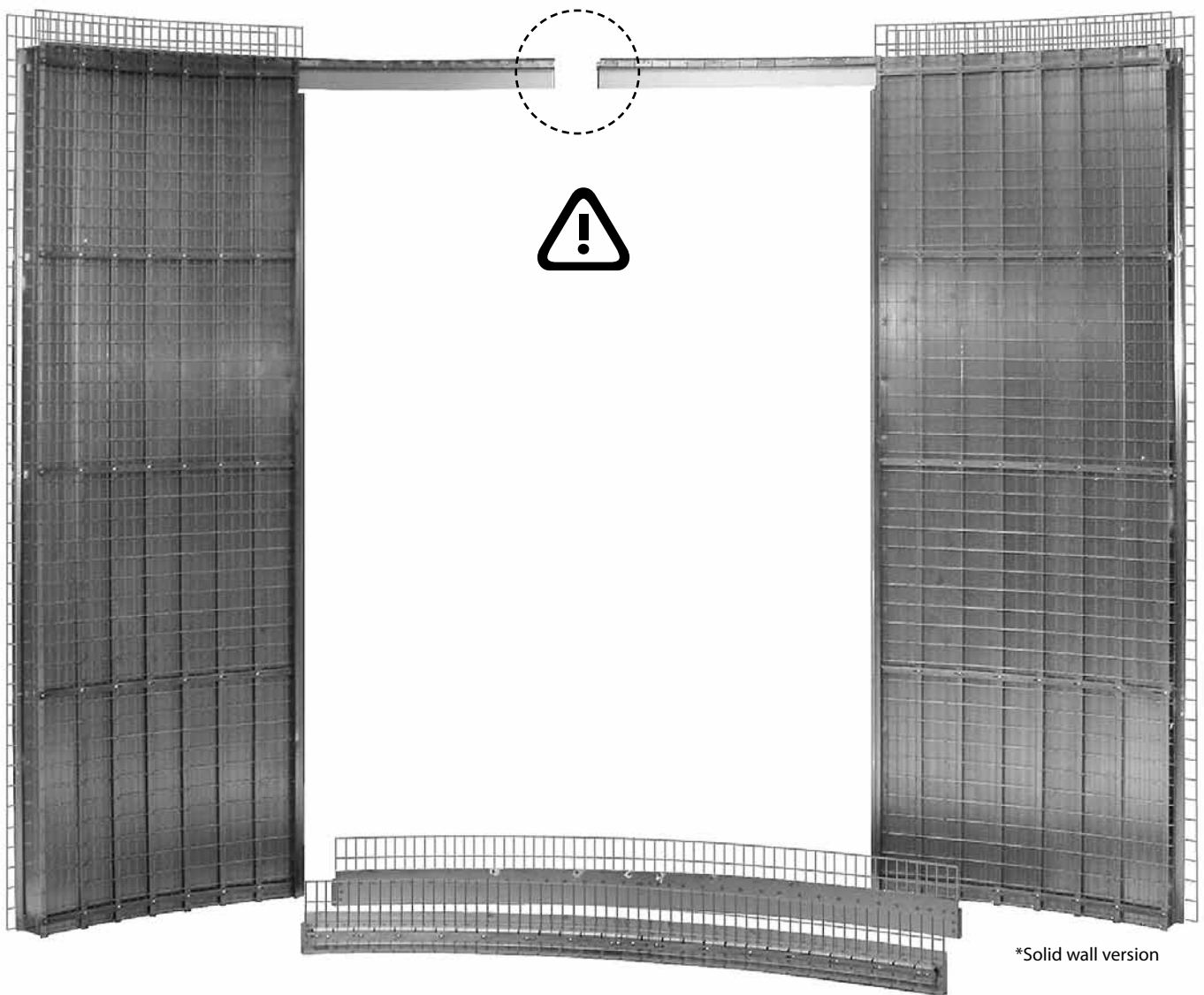

The double frame assembly for solid walls comes with the central, inner and outer fascias unassembled.

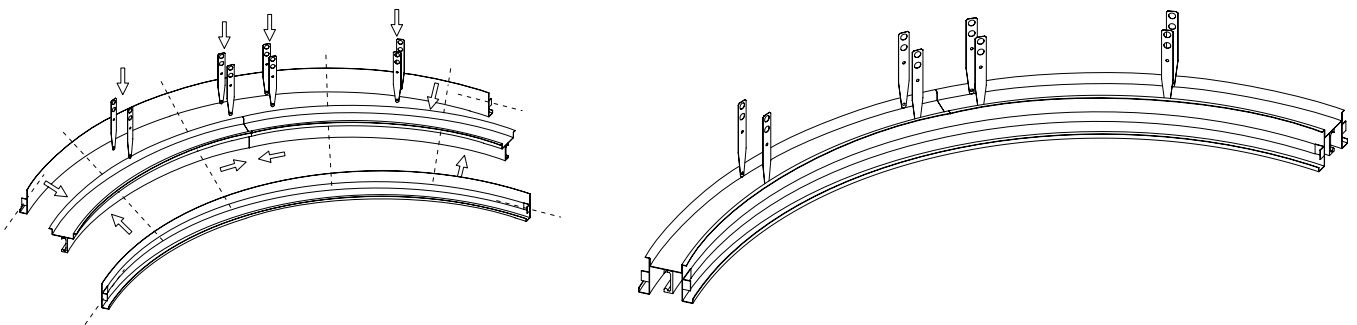

Join the two sides using the fascias.

Stud wall version: use the vertical ties to attach the frame to the stud work
Solid wall version: cement the vertical ties into the structure

DOUBLE FRAME ASSEMBLY

9

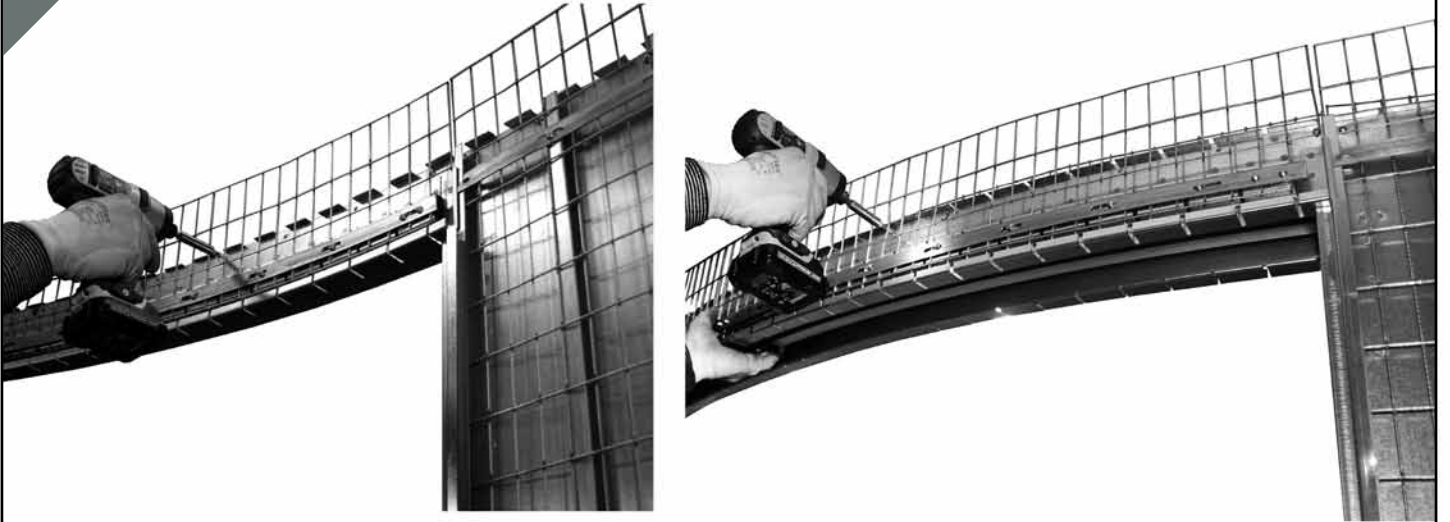

The fascias must be fixed using the existing holes.
Check alignment.

10



10a) Remove the templates.

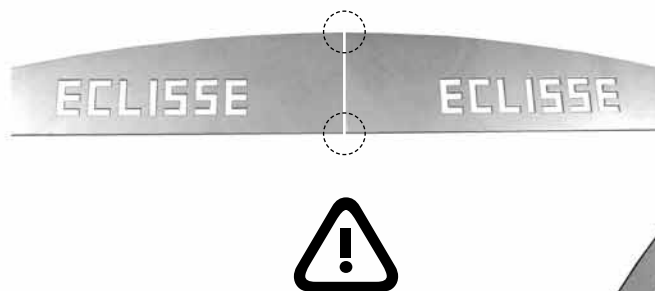

10b) Join the templates in the position
you want the pockets installed.



10c) Trace around the edge.

DOUBLE FRAME ASSEMBLY

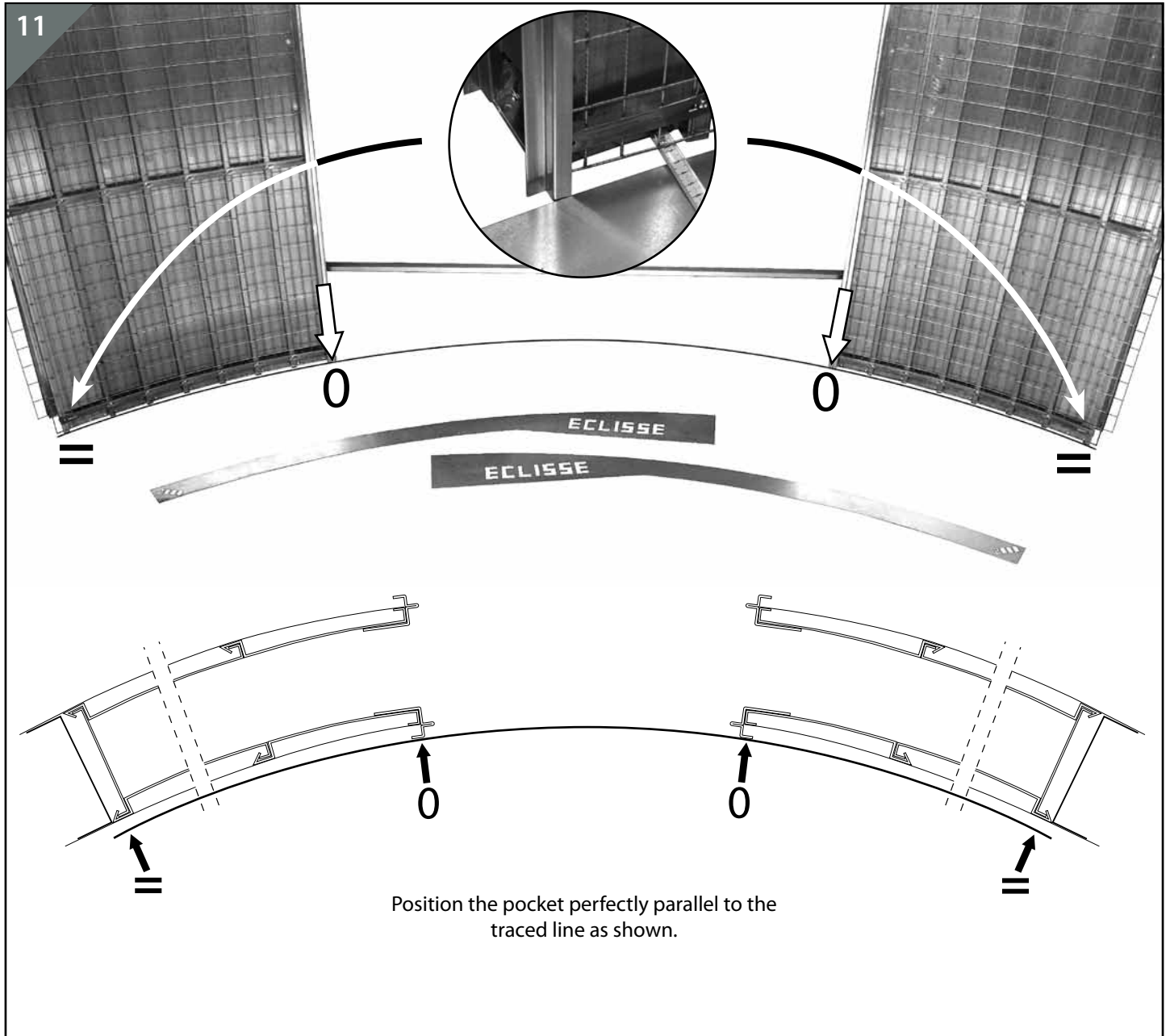

STUD WALL VERSION

See phase 5
See phase 6a
See phase 7a

SOLID WALL VERSION

See phase 5
See phase 7b



Terms and conditions of
the guarantee:
www.eclisseworld.com



ECLISSE s.r.l.
Via Sernaglia, 76 - 31053 Pieve di Soligo TV - ITALY
Tel. +39 0438 980 513 - Fax +39 0438 980 804
international.sales@eclisse.it - www.eclisseworld.com

09/2012 © ECLISSE, all rights reserved.-The use, filing and total or partial reproduction, using any mechanical or electronic means, of texts, drawings and pictures contained in this publication is strictly prohibited, unless specifically approved in writing by ECLISSE. 603019500